

## 90 degree panel touch elbow

### ●Millimeter size type

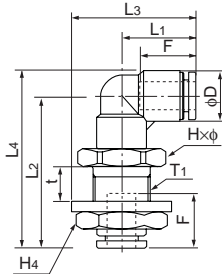

Product number	Applicable tube outer diameter (mm)	L <sub>1</sub> (mm)	L <sub>2</sub> (mm)	L <sub>3</sub> (mm)	L <sub>4</sub> (mm)	F Tube insertion length (mm)	H× $\phi$ Width across flat (mm)	H <sub>4</sub> Width across flat (mm)	t Max. panel thickness (mm)	T <sub>1</sub> Recommended panel hole diameter (mm)	D (mm)	Washer outer diameter (mm)	Washer thickness (mm)	Min. inner diameter (mm)	Effective cross-sectional area (mm <sup>2</sup> )	Weight (g)
APL4	4	17.2	35.6	27.7	40.5	13	17.0×18.3	17.0	7.5	13	9.8	21	2.5	3.0	—	32.0
APL6	6	18.5	40.0	30.5	46.3	15	19.0×21.0	19.0	9.0	15	12.6	24	2.5	5.0	—	43.0
APL8	8	20.7	43.6	34.7	47.5	16	22.0×24.5	22.0	10.0	17	14.6	28	3.0	7.0	—	62.0
APL10	10	24.7	51.6	41.7	60.3	19	27.0×30.0	27.0	14.0	21	17.5	34	3.0	9.0	—	101.0
APL12	12	26.3	56.0	44.8	66.0	20	30.0×33.5	30.0	16.0	23	20.0	37	3.0	10.0	—	126.0



## Reducer

### ●Millimeter size type



Product number	Applicable tube outer diameter (mm)	D <sub>1</sub> Insertion part diameter (mm)	L (mm)	L <sub>10</sub> (mm)	F Tube insertion length (mm)	D (mm)	Min. inner diameter (mm)	Effective cross-sectional area (mm <sup>2</sup> )	Weight (g)
AR4-6	4	6	30.4	13.9	13	10.0	3.0	3.5	8.0
AR4-8	4	8	30.9	13.9	13	10.0	3.0	3.5	11.0
AR6-8	6	8	31.8	14.8	15	12.0	5.0	10.5	11.0
AR6-10	6	10	34.3	15.8	15	12.0	5.0	10.5	17.0
AR6-12	6	12	35.8	15.8	15	13.0	5.0	10.5	25.0
AR8-10	8	10	34.9	16.4	16	13.9	7.0	28.0	15.0
AR8-12	8	12	36.4	16.4	16	13.9	7.0	28.0	22.0
AR10-12	10	12	41.4	21.4	19	16.9	7.0	45.0	23.0

⚠ Caution: Once a reducer is inserted into a PushOne part, the part cannot be used to connect a tube.

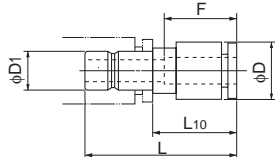

## Adopter elbow

### ●Millimeter size type



Product number	Applicable tube outer diameter (mm)	D <sub>1</sub> Insertion part diameter (mm)	L <sub>1</sub> (mm)	L <sub>2</sub> (mm)	L <sub>3</sub> (mm)	L <sub>4</sub> (mm)	L <sub>10</sub> (mm)	F Tube insertion length (mm)	D (mm)	Min. inner diameter (mm)	Effective cross-sectional area (mm <sup>2</sup> )	Weight (g)
AAL4	4	4	17.2	30.7	22.1	35.6	14.7	13	9.8	3.0	4.0	6.0
AAL6	6	6	18.5	34.2	24.4	40.5	17.7	15	12.6	4.5	12.0	10.0
AAL8	8	8	20.7	35.7	27.6	43.0	18.7	16	14.6	6.0	20.0	14.0
AAL10	10	10	24.7	41.2	33.0	50.0	22.7	19	17.5	8.0	35.0	22.0
AAL12	12	12	26.3	45.2	35.7	55.2	25.2	20	20.0	10.0	43.0	30.0

⚠ Caution: Once an adopter elbow is inserted into a PushOne part, the part cannot be used to connect a tube.

